

Scale 1:12,000 ↑ © Crown copyright Exeter City Council 100025345 22/01/2010

Newcourt Masterplan Area

Planning Services, Exeter City Council, Civic Centre, Paris Street, Exeter, EX1 1NN

Based upon the Ordnance Survey mapping with the permission of the Controller of Her Majesty's Stationary Office (c) Crown copyright. Unauthorised reproduction infringes Crown copyright and may lead to prosecution or civil proceedings.



EXETER LOCAL PLAN 1st Review

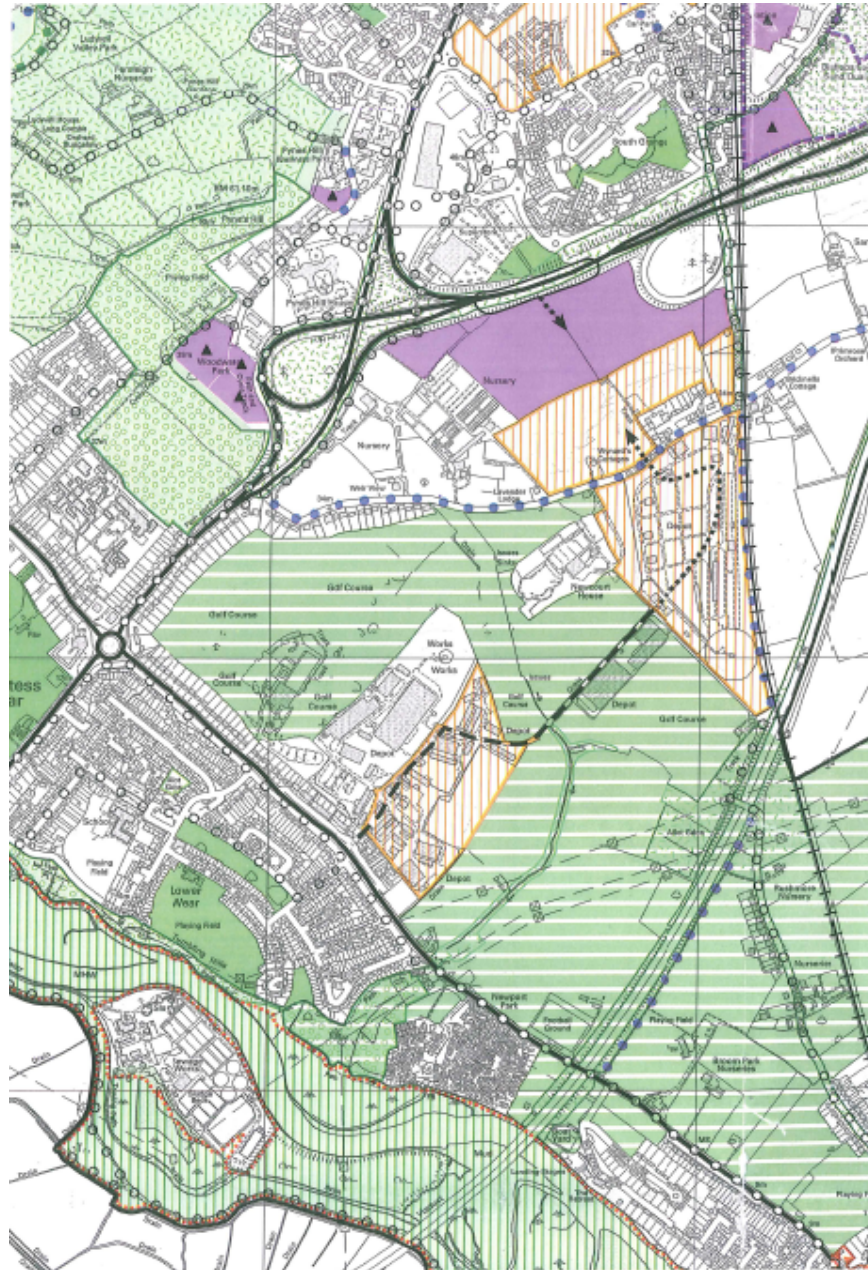

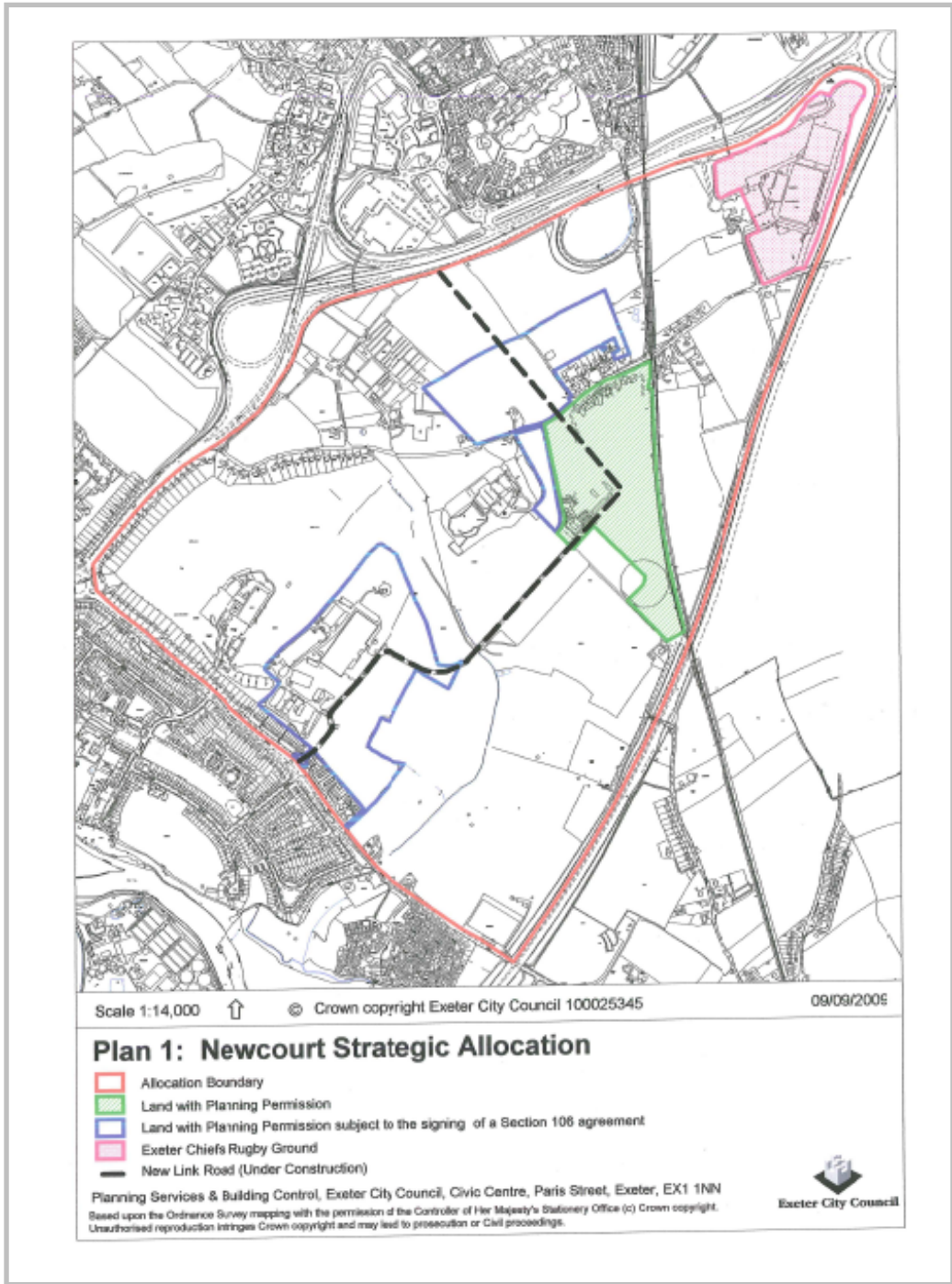



Scale 1:8,000

© Crown copyright Exeter City Council 100025345

05/10/2008

Planning Services, Exeter City Council, Civic Centre, Paris Street, Exeter, EX1 1NN



Based upon the Ordnance Survey mapping with the permission of the Controller of Her Majesty's Stationery Office (© Crown copyright). Unauthorised reproduction infringes Crown copyright and may result in prosecution or civil proceedings.

SWOT Analysis for Development Potential

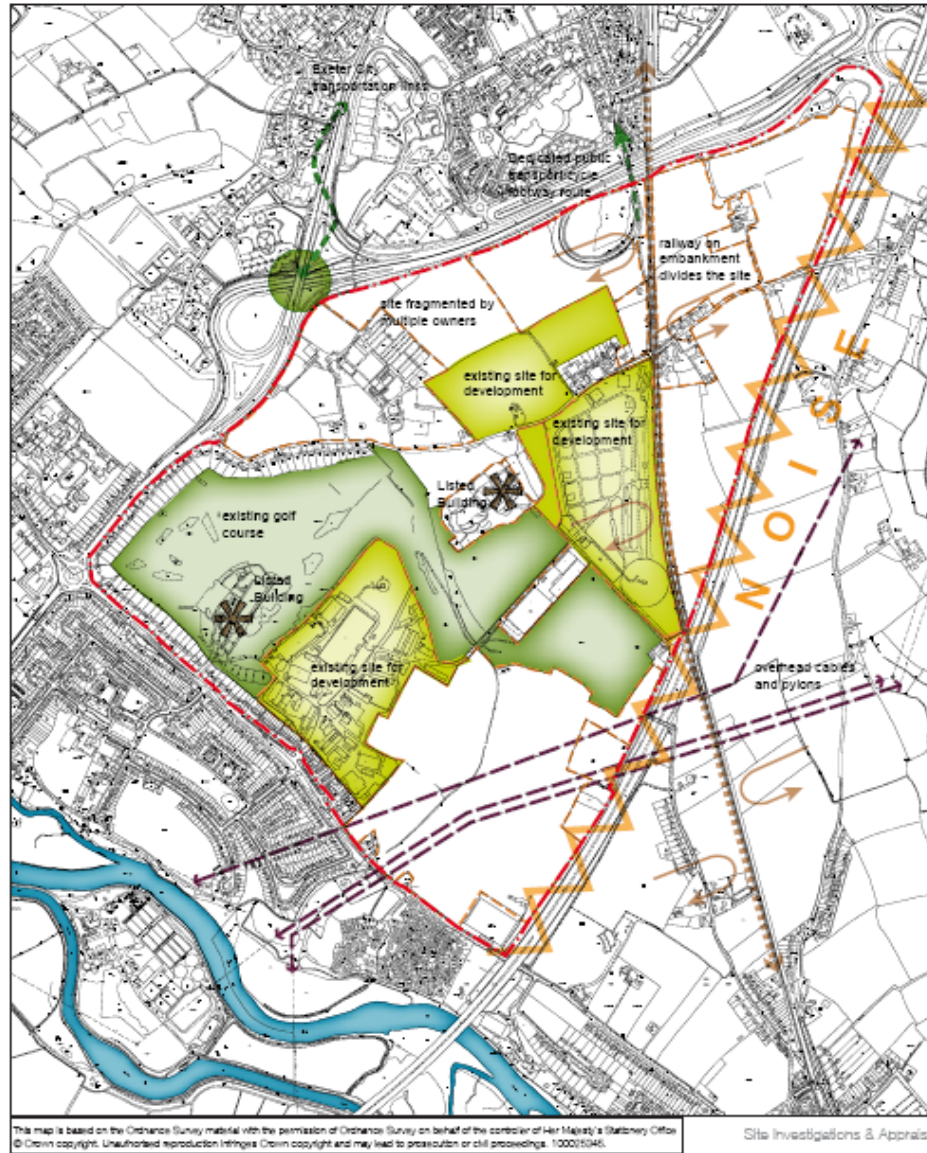

Transport Infrastructure Framework

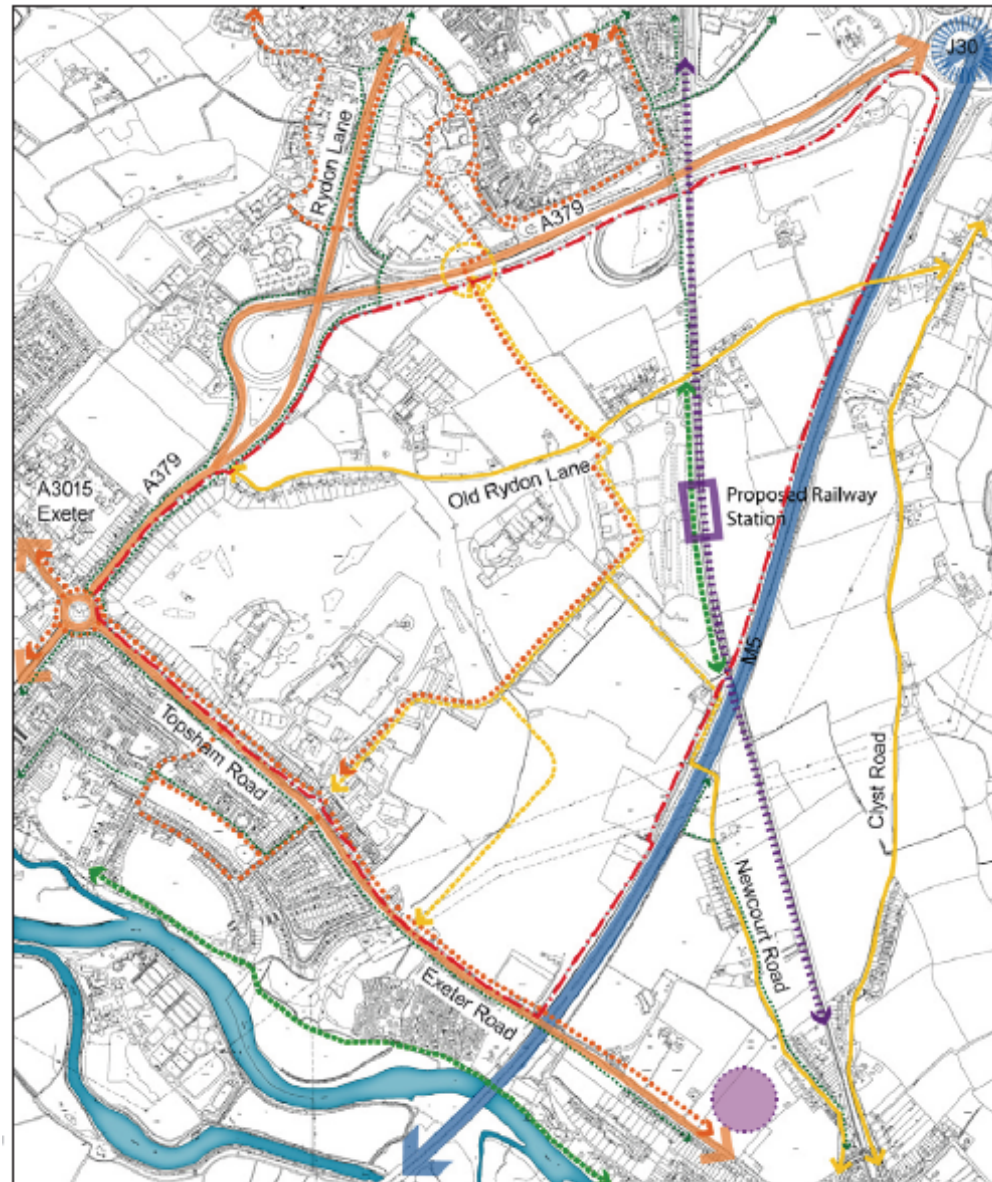

This map is based on the Ordnance Survey material with the permission of Ordnance Survey on behalf of the controller of Her Majesty's Stationery Office © Crown copyright. Unauthorised reproduction infringes Crown copyright and may lead to prosecution or civil proceedings. 100025046.

Concept Development

AREA GI FRAMEWORK

THE AREA FRAMEWORK PLAN

The Newcourt Area Framework Plan (Figure 5) illustrates the opportunities as set out on the previous pages that will help to achieve the GI aims for this area.

- Area Framework Boundary
- Priority Projects**
- Exe Riverside Valley Park (inc. Ludwell Valley Park)
- The Lower Clyst
- Sustainable Movement Network**
- 'Greenways' - existing and enhanced
- Key cycle/footpaths on quiet roads
- Key cycle/footpaths off road - existing and enhanced
- Key cycle/footpath off road - proposed
- New foot/cycle bridge
- New or enhanced road crossing
- Biodiversity Network**
- Key Habitat Links
- Ramsar, SSSI and SPA
- Site of Nature Conservation Interest
- Site of Local Importance for Nature Conservation
- Other Programmes**
- Parish Boundary Enhancement Scheme
- City Open Spaces Programme
- Position of 'doorstep to countryside' section (see next page)

0 0.5 Kilometers

This map is reproduced from Ordnance Survey material with the permission of Ordnance Survey on behalf of the Controller of the Majesty's Stationery Office. © Crown copyright. Unauthorised reproduction infringes Crown copyright. Unauthorised reproduction infringes Crown copyright and may lead to prosecution and penalties. Licence number: 100032248 - 2008

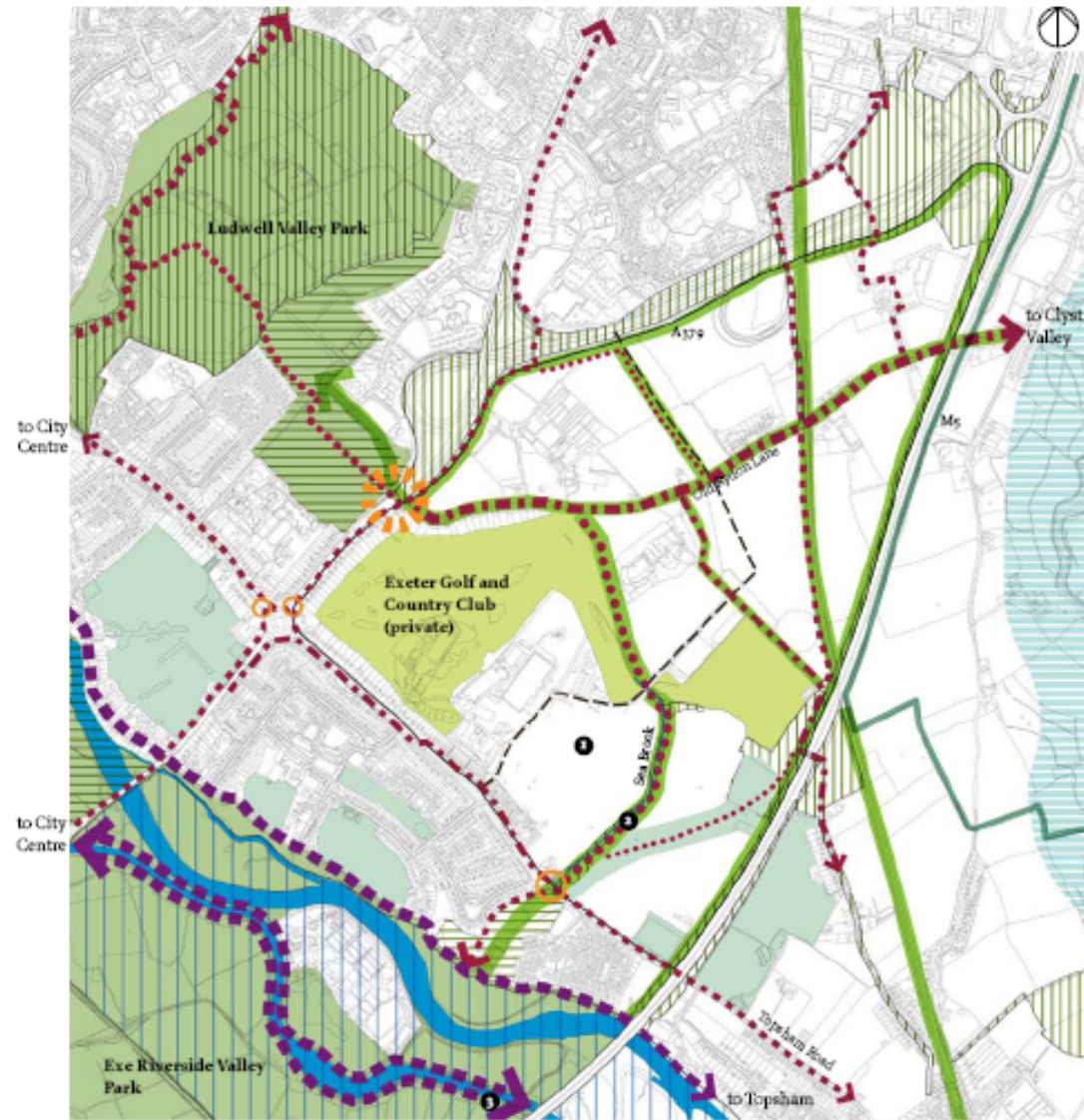

FIGURE 5: NEWCOURT AREA FRAMEWORK PLAN

